



# QSteel 2009

New Add-On for Quickduct CAD

Shop Data Systems, Inc. introduces the latest in its line of CAD offerings, QSteel 2009. QSteel is a light steel application designed specifically for the HVAC detailer that needs a little extra. QSteel requires Quickduct CAD to be installed and sits inside the AutoCAD platform right next to Quickduct. Simultaneously draw structural steel shapes and ductwork in the same drawing. You no longer need to rely on 2D representations of structural steel, and you no longer have to wait for the structural detailer to provide you with 3D drawings. With industry standard shapes and easy to use features, QSteel allows Quickduct users to quickly and easily draw the necessary structural steel shapes.

New  
Product

## Industry Standard Shapes

QSteel's structural library is built upon industry standard shapes. Right out of the box the detailer has access to all standard forms of AISC shapes. Users also have the ability to create custom joists. The QSteel library can be

customized to suit your company's needs and can work from a server in order to provide efficient use of any changed database; whether that change be to add a shape to the standard library or to create a custom joist shape, the QSteel library can be easily shared among all detailers.

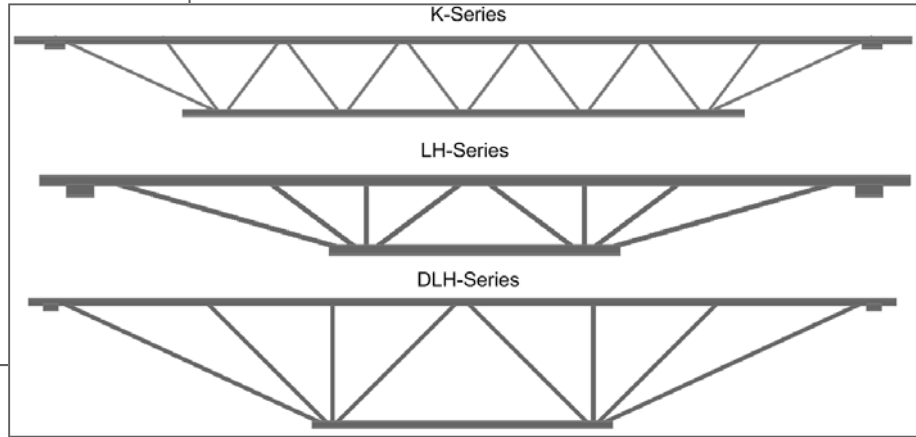
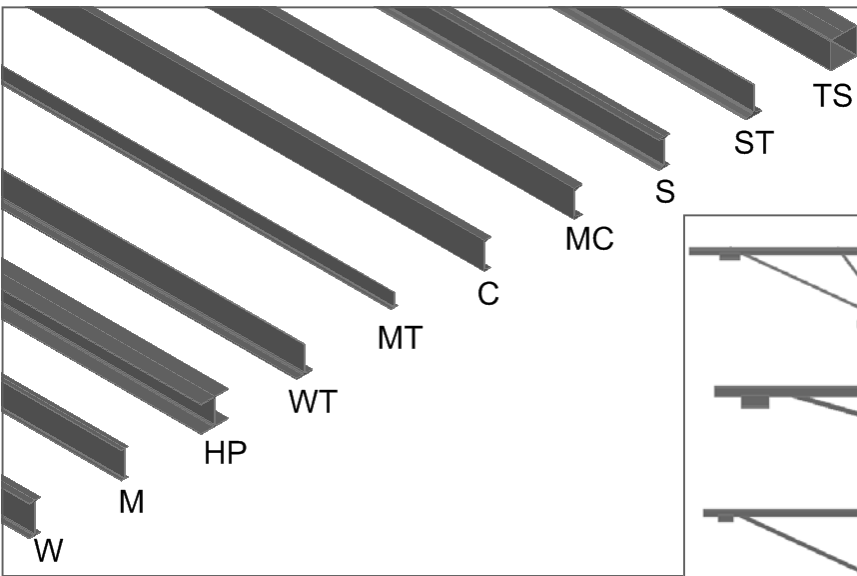

## Shape Arrays

QSteel provides features to quickly draw Columns, Beams, and Joists. The Column Array can automatically pick up intersections along the structural drawing's column lines and apply the specified shape. The Beam Array will follow the beam lines from the structural drawing and extrude the specified shape along the line. The Joist Array works similarly to the Beam Array but extrudes the specified joist shape. QSteel makes drawing structural items quick and easy.

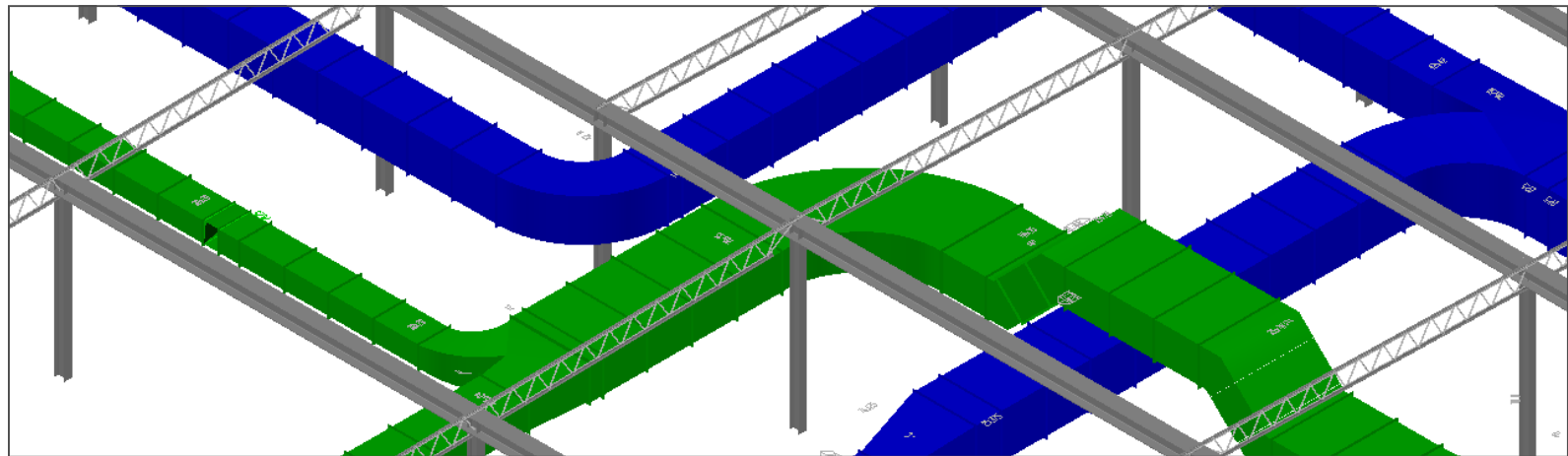

BARJOISTDLH SERIES

General	
TrueColor	<input type="checkbox"/> ByLayer
Layer	0
Linetype	ByLayer
LinetypeScale	1.0000
PlotStyleName	ByColor
Lineweight	ByLayer
Hyperlinks	
Material	ByLayer
Geometry	
Start X	59'-10"
Start Y	26'-6 7/16"
Start Z	-13'-10 5/16"
End X	87'-2 1/4"
End Y	26'-6 7/16"
End Z	-13'-10 5/16"
Data	
Name	52DLH10
Length	27'-4 1/4"

## Properties Palette Integration

All QSteel shapes can be modified with the AutoCAD Properties Palette. QSteel lists the start and end coordinates, shape name, and shape length. The shape name can be changed to any shape name in the QSteel library.

## Shape Stretch

All QSteel objects have stretch points on both ends and can be stretched into the appropriate length. The joist shapes have intelligence when stretched. If a joist is stretched to a point where the web can not be created, the user will see a warning message stating it can not be drawn.

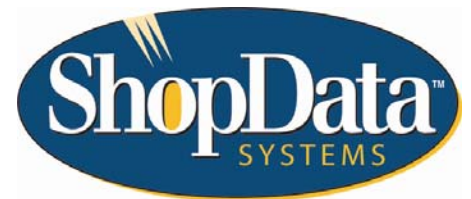

**Call today for your personalized product demonstration!!**

Shop Data Systems, Inc. P: 972-494-2719  
 712 East Walnut Street. F: 972-272-7062  
 Garland, Texas 75040 www.shopdata.com